



Principles and Mechanisms

Standard level switch with various lever lengths of standard length. It can be used in small oil and water tank to detect the height and temperature of liquid level.

The characteristics of

- ◆ Optional integrated liquid temperature detection
- ◆ Flange or thread connection
- ◆ Resistance to high temperature of 105
- ◆ The protection level is IP65
- ◆ 70V/0.75A
- ◆ Brass material withstands 20bar pressure, stainless steel 60bar pressure
- ◆ DIN43650 electrical connection, M12 navigation plug optional

Selection table

F201	50	NO	--	--	G	H	--	detailed
F201								Float type level switch
	XX							First switching point L (unit mm)
		NO						Normally open output
		NC						Normally closed output
			--					Second switch point LXXX (unit: mm) Optional
				NO				Normally open output
				NC				Normally closed output
					G			Threaded Installation G1
					D			Flange installation
						H		Hirsmann plug DIN43650
						M		M12*1 air plug
							60	Temperature switch value, optional NO/NC Normally open /Normally closed Optional
							NO	

Size chart

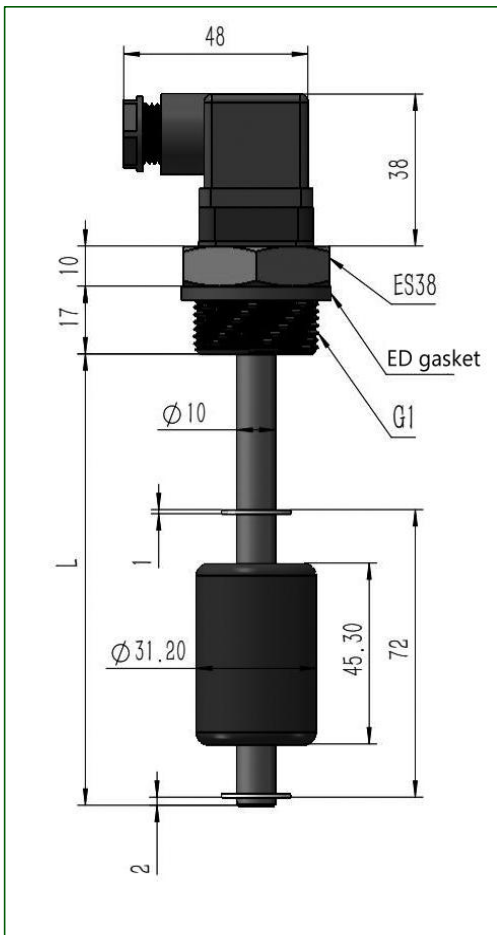

Flange dimension drawing

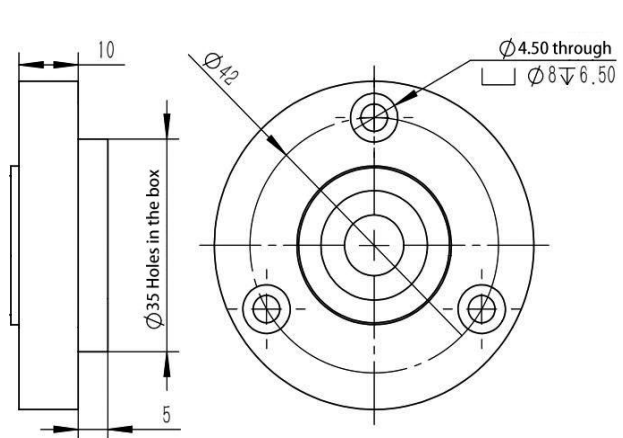

Applicable medium

